



BLAINE POLICE DEPARTMENT NEWS RELEASE

January 4, 2012

BLAINE SETS BOUNDARIES FOR 2012 BOW AND ARROW SPRING TURKEY HUNTING SEASON

The City of Blaine has set the below boundaries for the 2012 bow and arrow spring turkey hunting season. The State of Minnesota has established the dates for the hunting season as running from April 18 to May 31, 2012. Applications are now available from the DNR for the 2012 spring turkey hunting season. The application deadline is January 13, 2012.

Northern Hunt Area

ALL OF SEC 1 TWP 31 RGE 23; TOG W/ ALL OF SEC 2 TWP 31 RGE 23, EX THE SW $\frac{1}{4}$ OF THE SW $\frac{1}{4}$ AND THE NW $\frac{1}{4}$ OF THE SW $\frac{1}{4}$ AND THE W $\frac{1}{2}$ OF THE SW $\frac{1}{4}$ OF THE NW $\frac{1}{4}$; TOG W/ THE NE $\frac{1}{4}$ OF THE NE $\frac{1}{4}$ OF THE SEC 3 TWP 31 RGE 23; TOG W/ THAT PART OF SEC 11 TWP 31 RGE 23 DESC AS FOL, THE EAST $\frac{1}{2}$ OF THE NW $\frac{1}{4}$ AND THE EAST $\frac{1}{2}$ OF THE SE QUARTER AND THE NE $\frac{1}{4}$, EX THE S 123.38 FT OF THAT PRT OF THE N $\frac{1}{2}$ OF THE NE $\frac{1}{4}$ EX THE W 1170 FT THEREOF & THE N 176.62 FT OF THE S $\frac{1}{2}$ OF SD NE $\frac{1}{4}$ EX THE W 1170 FT THEREOF ALSO EX RDS SUBJ TO EASE OF REC; TOG W/ ALL OF SEC 12 TWP 31 RGE 23, EX THE NE $\frac{1}{4}$ OF THE SW $\frac{1}{4}$ AND THE S $\frac{1}{2}$ OF THE SW $\frac{1}{4}$ AND THE SW $\frac{1}{4}$ OF NE $\frac{1}{4}$ AND THE E $\frac{1}{2}$ OF THE NW $\frac{1}{4}$ OF THE NE $\frac{1}{4}$.

Southern Hunt Area

THAT PART OF THE NE $\frac{1}{4}$ OF SEC 22 TWP 31 RGE 23 TOG W/ THAT PART OF THE NW $\frac{1}{4}$ SEC 23 TWP 31 RGE 23 EX; THAT PRT OF SW $\frac{1}{4}$ OF NW $\frac{1}{4}$ OF SEC 23 TWP 31 RGE 23 DESC AS FOL: BEG AT A PT ON W LINE OF SD $\frac{1}{4}$ $\frac{1}{4}$ 890.6 FT N OF SW COR THEREOF, TH E PRL/W S LINE OF SD $\frac{1}{4}$ $\frac{1}{4}$ 507.3 FT, LINE OF SD $\frac{1}{4}$ $\frac{1}{4}$ 507.3 FT, TH N PRL/W SD W LINE 429.4 FT TO N LINE OF SD $\frac{1}{4}$ $\frac{1}{4}$, TH W ALG SD N LINE 507.3 FT +OR- TO SD W LINE, TH S ALG SD W LINE TO POB, SUBJ TO EASE OF REC AND UNPLATTED CITY OF BLAINE THAT PART OF THE SW $\frac{1}{4}$ OF NW $\frac{1}{4}$ SEC 23 TWP 31 RGE 23 DESC AS FOL, BEG AT A POINT ON THE W LINE OF SAID SW $\frac{1}{4}$ OF NW $\frac{1}{4}$ 455 FT N OF THE SW $\frac{1}{4}$ TH ELY PRL TO THE S LINE OF SAID SW $\frac{1}{4}$ A DIST OF 500 FT, TH NLY PRL TO THE W LINE OF SAID SW $\frac{1}{4}$ A DIST OF 435.6 FT, TH WLY PRL TO THE S LINE OF SAID SW $\frac{1}{4}$ A DIST OF 500 FT MORE OR LESS TO THE W LINE OF SAID SW $\frac{1}{4}$, TH SLY TO THE PT OF BEG (SUBJ TO PUBLIC ROAD OVER & UPON THE WLY 33 FT THEREOF.)

Persons wishing to hunt must contact a landowner within the designated hunting areas. There is no hunting allowed on park property or city-owned property. Property owners within the designated hunting areas who wish to allow hunting on their land are required to give written permission to the hunter. Persons hunting on designated property must have in “**their immediate possession**”, the written permission of the property owner allowing them to hunt and identification. Persons found hunting in the areas without a written note from the landowner are subject to fines up to \$1,000 and/or 90 days in jail, as well as confiscation of their equipment. Hunters would still need to obtain all the required State of Minnesota, Department of Natural Resources Hunting Licenses and follow all of the State laws, rules and regulations regarding bow and arrow hunting for turkeys. Those wishing further information may contact the Blaine Police Department at 763-785-6132. A map of the designated approved hunting area is available upon request and a copy is posted on the “Legal Notices” board in the Blaine City Hall.

Clark Arneson, City Manager

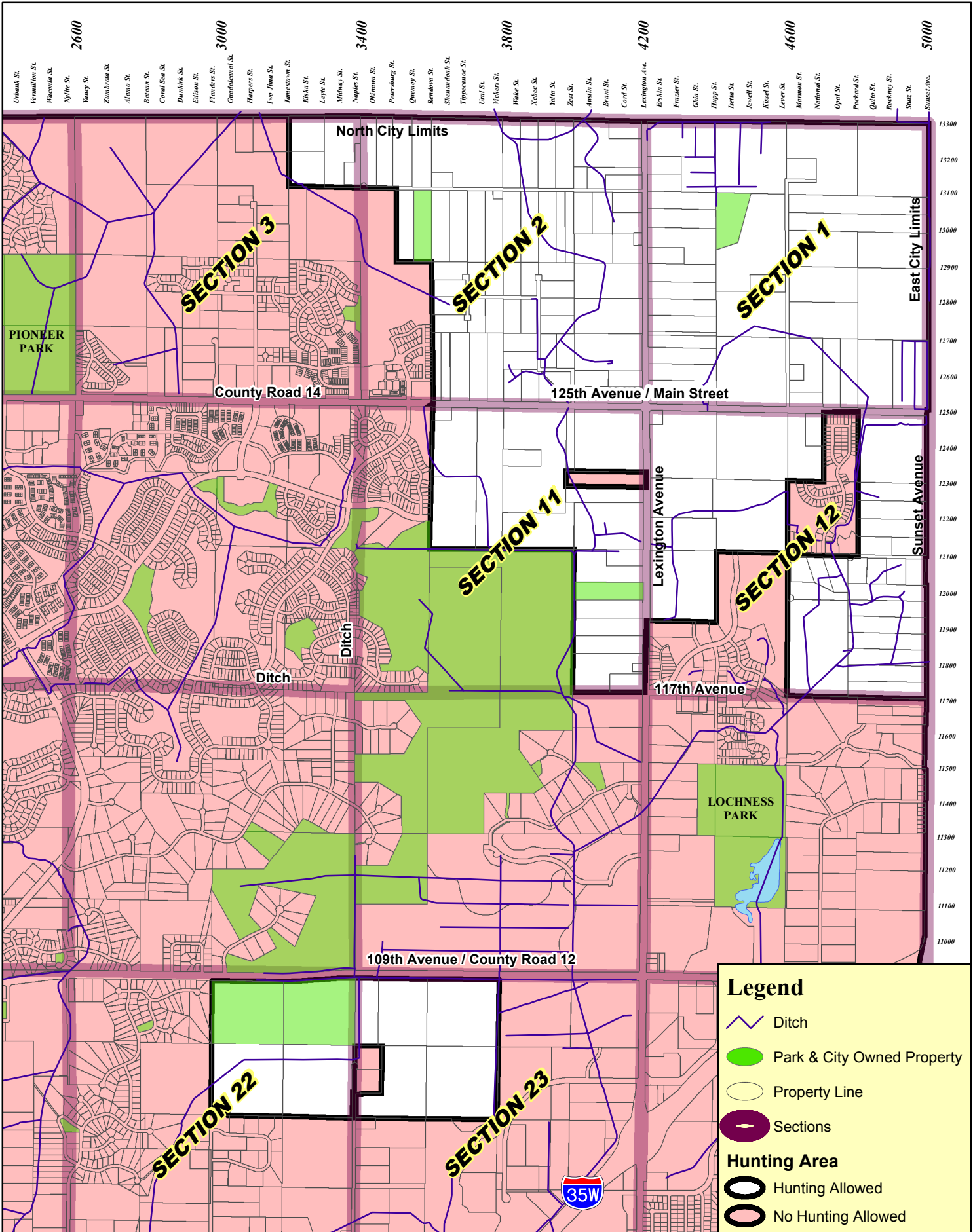

Legend

- Ditch
- Park & City Owned Property
- Property Line
- Sections

Hunting Area

- Hunting Allowed
- No Hunting Allowed

2012 SPRING TURKEY HUNTING BOUNDARIES